

Wyoming Youth in **S.T.E.M**



presents

2025 Women in STEM conference

May 20, 2025

**Central Wyoming College
Riverton, Wyoming**



www.wyyouthinstem.org

Conference Schedule

When	What	Where
9:00-9:30 am	Registration/Career Exploration Displays/Breakfast	Gymnasium
9:30-9:35 am	Group/travel for Workshop 1	Gymnasium
9:35-10:35 am	Workshop 1	Health & Science Center
10:35-10:40 am	Travel to Workshop 2	Health & Science Center
10:40-11:40 am	Workshop 2	Health & Science Center
11:40-12:15 pm	Lunch/Career Exploration Displays	Gymnasium
12:15-12:20 pm	Group/travel for Workshop 3	Gymnasium
12:20-1:20 pm	Workshop 3	Health & Science Center
1:20-1:30 pm	Travel back to Gymnasium	-
1:30-2:15 pm	Closing Ceremonies/Door Prizes	Gymnasium

Thank you to our sponsors!



Workshops

	Presenter	Workshop	Classroom
A	Sarah Lukes	<i>Discover How Light is Used in Technology</i>	HS107
B	Emily Baker	<i>Crack the Case: Solve the Crime Like a Forensic Scientist</i>	HS109
C	Crystal Reynolds	<i>Tribal Archeology</i>	HS110
D	Kathryn Bungartz	<i>See DNA With Your Own Eyes</i>	HS111
E	Monica Bun	<i>Mycology Exploration: The Hidden World of Mushrooms</i>	HS112
F	Caitlin Blackburn	<i>Veterinary Super Power: X-Ray Vision</i>	HS114
G	Mara Gans	<i>Why All Maps Lie: Making the Round World Flat</i>	HS206
H	Olivia Maxwell, a'Lisa Hoffman	<i>GPS Scavenger Hunt, A Tool in the Tool Box</i>	HS208
I	SageWest Healthcare	<i>Medical Mystery Escape Room</i>	HS210
J	Shannon Bendtsen	<i>Fire and Water</i>	HS214
K	Sandy Watkins	<i>Journeyman Lineman</i>	outside

**MATH
ROCKS**



Career Exploration Displays

Display	Website
Bureau of Land Management	https://www.blm.gov/
Bureau of Land Management/Fire	https://www.blm.gov/programs/fire
Central Wyoming College/Admissions	https://www.cwc.edu/admissions
Central Wyoming College/Meat Science	https://www.cwc.edu/meatscience/
Central Wyoming College/Equine Science	https://www.cwc.edu/equine-science/
Federal Bureau of Investigation	https://www.fbi.gov/
Fremont County Sheriff Department	https://www.fremontcountywy.org/
Inberg-Miller Engineers	https://inberg-miller.com/
Nat'l Bighorn Sheep Interpretive Center	https://bighorn.org/
SageWest Healthcare	https://www.sagewesthealthcare.com
Society for Mining, Metallurgy & Exploration	https://www.smenet.org/
Sugar Association	https://www.sugar.org/
Tata Chemicals	https://www.tatachemicals.com/
The Stock Doc Veterinary Services	https://rivertonvet.com/
U.S. Fish & Wildlife Service	https://www.fws.gov/
WESoda	https://wesoda.com/
Wind River Job Corps	https://windriver.jobcorps.gov/
Wind River Tribal Buffalo Initiative	https://windriverbuffalo.org/

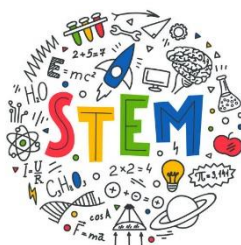

2025 Women in STEM

The 2025 Women in STEM conference will be in buildings 10 (Rustler Gymnasium) and 11 (Health & Science Center)

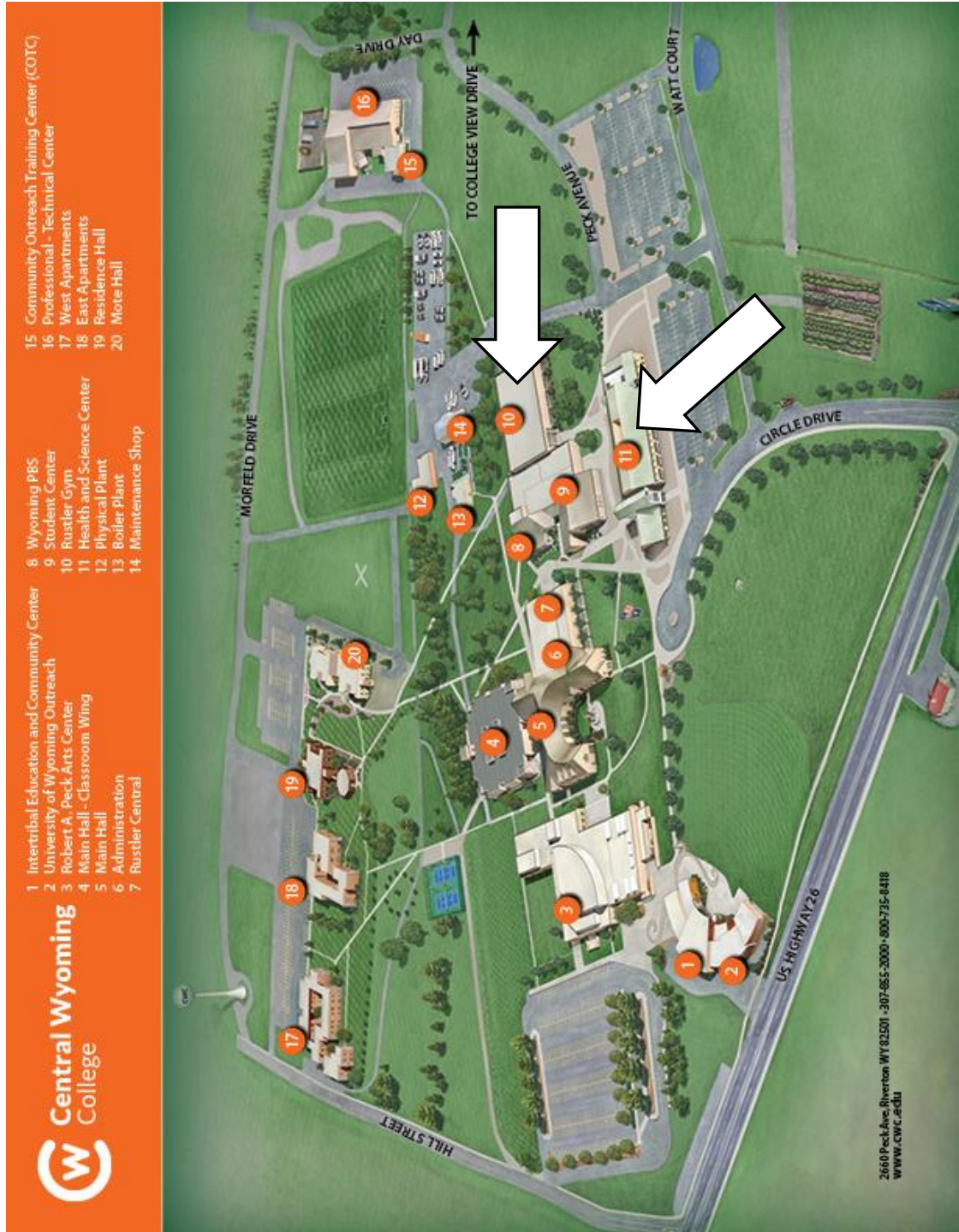

Health & Science Center

Ground Floor

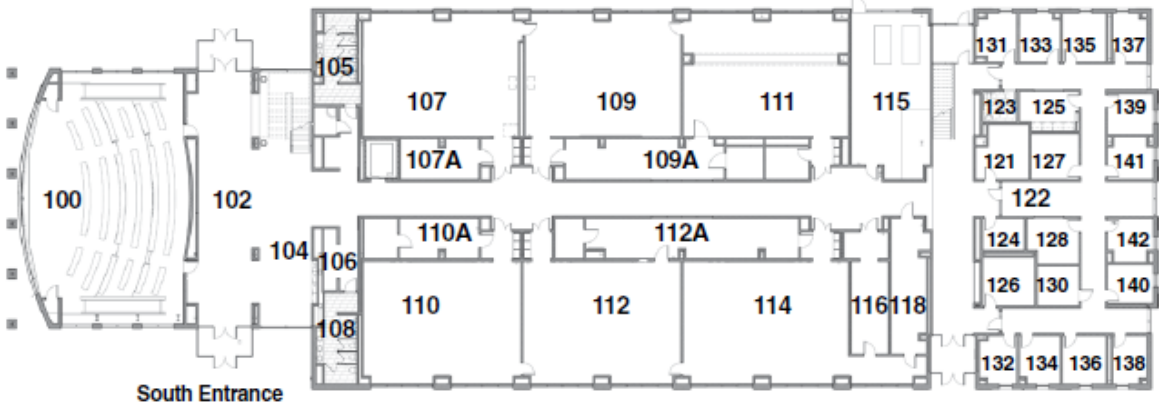

LEGEND

FIRST FLOOR	HS111 Anatomy Lab	SECOND FLOOR	HS212 A-C Allied Health
HS100 Lecture Auditorium	HS112 Biology Lab	HS200 Study Area	HS 213A Nursing Prep Area
HS102 Lobby	HS112A Prep Area	HS201 Vending	HS214 Computer Lab
HS104 Study Area	HS114 Chemistry/	HS202 Lobby	HS215 Nursing - Debrief
HS105 Women's Restroom	HS116 Microbiology Lab	HS204 Men's Restrooms	HS217 A-K Simulation Labs
HS106 Vending	HS118 INBRE Lab	HS205 Women's Restroom	HS218 Lab Storage
HS107 Physics, EHS Lab	HS118 Stock Room	HS206 Classroom	HS221 Equipment Storage
HS108 Men's Restroom	HS115 Mechanical	HS207A CNA Skills Lab	HS222 Reception
HS109 Physiology Lab	HS122 Reception	HS208 Computer Lab	HS223 Nursing Conference
HS109A Prep Area	HS 124 Custodial Storage	HS209 Nursing - Debrief	HS224 Staff Break Room
HS110 Earth Science/Geology Lab	HW126 Recycling	HS210 Classroom	HS231-242 Offices
HS110A Prep Area	HS127-142 Offices	HS 211 Nursing - Debrief	HS230 Study Area

Second Floor

