

Wyoming Youth in S.T.E.M



presents

2024 Women in STEM conference

May 15, 2024

**Central Wyoming College
Riverton, Wyoming**



www.wyyouthinstem.org

Conference Schedule

When	What	Where
9:00-9:30 am	Registration/Career Exploration Displays/Breakfast	Gymnasium
9:30-9:35 am	Group/travel for Workshop 1	Gymnasium
9:35-10:35 am	Workshop 1	Health & Science Center
10:35-10:40 am	Travel to Workshop 2	Health & Science Center
10:40-11:40 am	Workshop 2	Health & Science Center
11:40-12:15 pm	Lunch/Career Exploration Displays	Gymnasium
12:15-12:20 pm	Group/travel for Workshop 3	Gymnasium
12:20-1:20 pm	Workshop 3	Health & Science Center
1:20-1:30 pm	Student Evaluations (complete & collect)	Health & Science Center
1:30-1:40 pm	Travel back to Gymnasium	-
1:40-2:15 pm	Closing Ceremonies/Door Prizes	Gymnasium

Thank you to our sponsors!



DOWL



**Central Wyoming
College**



Workshops

Presenter	Workshop	Classroom
A Shannon Bendston	<i>Self-Driving Car</i>	HS107
B Kenny, Arcona	<i>Exploring How CO₂ Behaves in the Atmosphere</i>	HS109
C Crystal Reynolds	<i>Tribal Archeology</i>	HS110
D Hanna Holcomb	<i>Introduction to Nature Journaling</i>	HS111
E Toomey, Klein	<i>What is Soil Health & Why is it Important?</i>	HS112
F SageWest Health Care	<i>Medical Mystery Escape Room</i>	HS114
G Alex Walters	<i>Ecosystem Exploration</i>	HS206
H Kocialski, Morgan	<i>Reflect & Refract to Create Holograms</i>	HS208
I Lorre Hoffman	<i>Paper Ball Run: How SLOW Can You Go?</i>	HS210
J Hamner, Mickelson, Bingle-Davis	<i>Life Cycle of an Oil & Gas Prospect</i>	HS214
K Watkins, Heiner	<i>Journeyman Lineman</i>	outside

**MATH
ROCKS**



Career Exploration Displays

Display	Website
BIA/Forestry	https://www.bia.gov/bia/ots/dof
Bureau of Land Management	https://www.blm.gov/
Bureau of Land Management/Fire	https://www.blm.gov/programs/fire
Carbon Capture, Inc	https://www.carboncapture.com/
Central Wyoming College/Admissions	https://www.cwc.edu/admissions/
Central Wyoming College/Equine Science	https://www.cwc.edu/equine-science/
Central Wyoming College/Meat Science	https://www.cwc.edu/meatscience/
Central Wyoming College/Nursing	https://www.cwc.edu/nursing/
Federal Bureau of Investigations	https://www.fbi.gov
Fremont County Sheriff Department	https://www.fremontcountywy.org/
Genesis Alkali	https://www.genesisenergy.com/
Guardian EMS	https://www.guardianflight.com/
National Weather Service	https://www.weather.gov/
Raytheon Technologies	https://www.rtx.com/
SageWest Health Care	https://www.sagewesthealthcare.com
Tata Chemicals	https://www.tatachemicals.com/
U.S. Army	https://www.army.mil/
U.S. Fish & Wildlife Service	https://www.fws.gov/
U.S Patent & Trademark Office	https://www.uspto.gov/

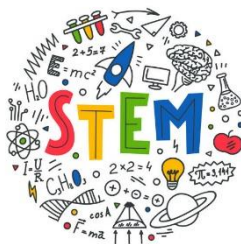

2024 Women in STEM

The 2024 Women in STEM conference will be in buildings 10 (Rustler Gymnasium) and 11 (Health & Science Center)

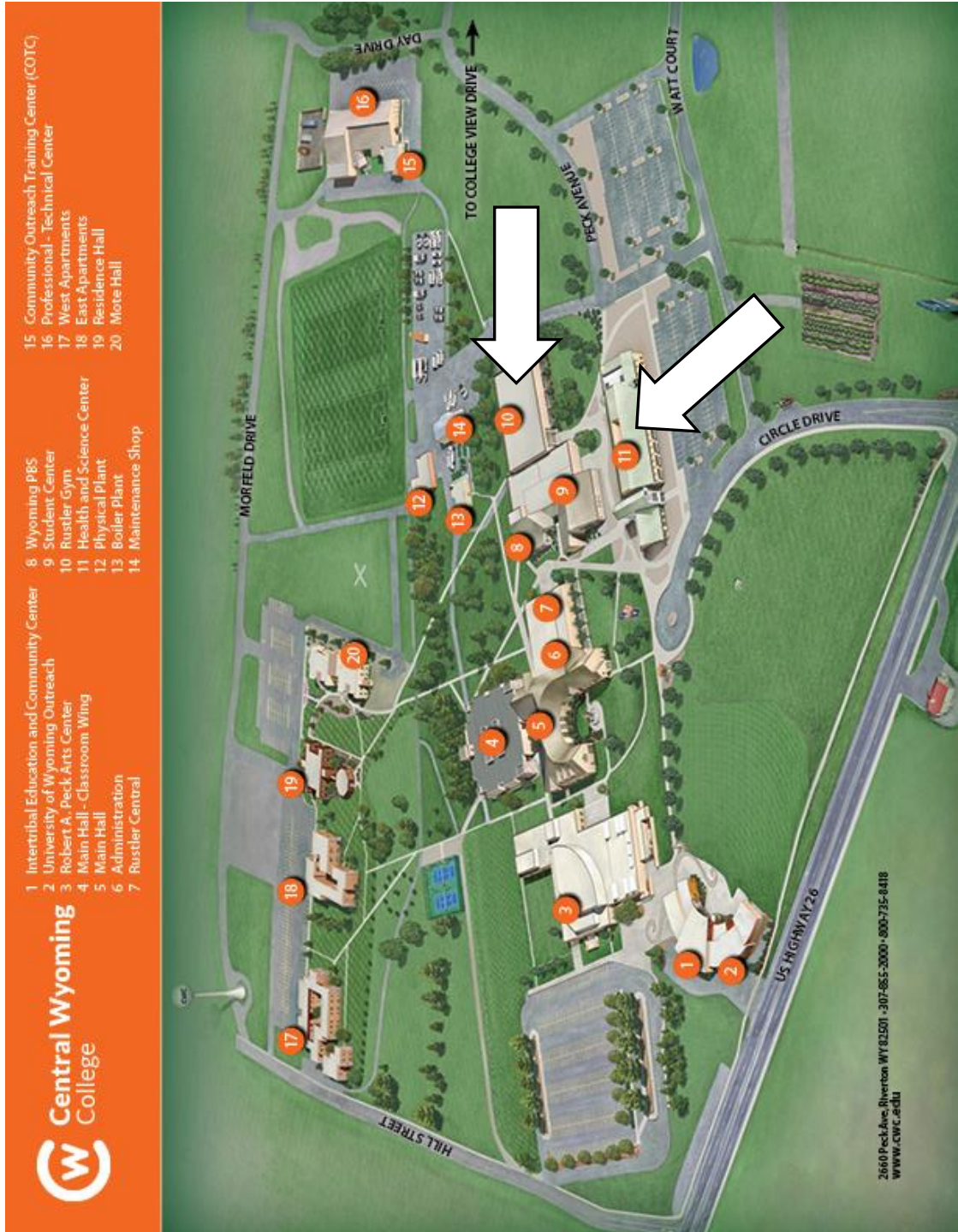

Health & Science Center

Ground Floor

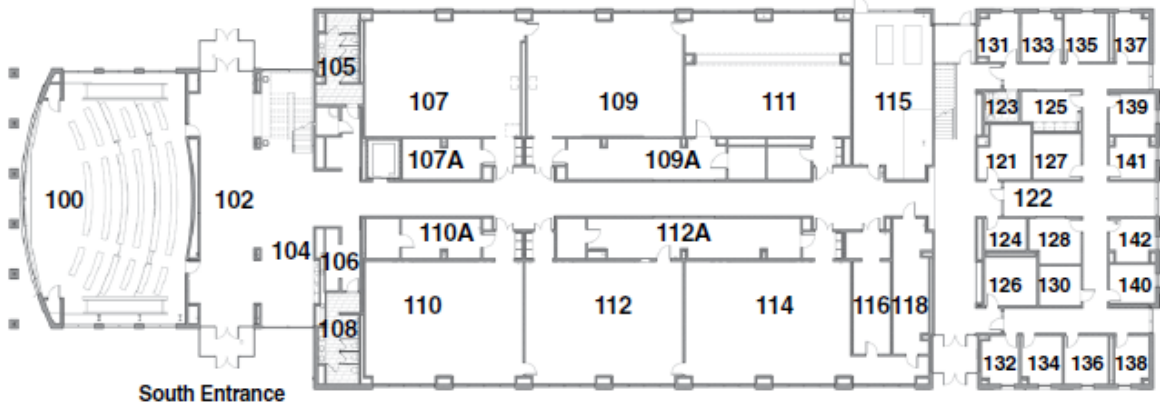

LEGEND

FIRST FLOOR

- HS100 Lecture Auditorium
- HS102 Lobby
- HS104 Study Area
- HS105 Women's Restroom
- HS106 Vending
- HS107 Physics, EHS Lab
- HS108 Men's Restroom
- HS109 Physiology Lab
- HS109A Prep Area
- HS110 Earth Science/Geology Lab
- HS110A Prep Area

- HS111 Anatomy Lab
- HS112 Biology Lab
- HS112A Prep Area
- HS114 Chemistry/ Microbiology Lab
- HS116 INBRE Lab
- HS118 Stock Room
- HS115 Mechanical
- HS122 Reception
- HS 124 Custodial Storage
- HW126 Recycling
- HS127-142 Offices

SECOND FLOOR

- HS200 Study Area
- HS201 Vending
- HS202 Lobby
- HS204 Men's Restrooms
- HS205 Women's Restroom
- HS206 Classroom
- HS207A CNA Skills Lab
- HS208 Computer Lab
- HS209 Nursing - Debrief
- HS210 Classroom
- HS 211 Nursing - Debrief

- HS212 A-C Allied Health
- HS 213A Nursing Prep Area
- HS214 Computer Lab
- HS215 Nursing - Debrief
- HS217 A-K Simulation Labs
- HS218 Lab Storage
- HS221 Equipment Storage
- HS222 Reception
- HS223 Nursing Conference
- HS224 Staff Break Room
- HS231-242 Offices
- HS230 Study Area

Second Floor

